

PRESTRESSED CONCRETE PILING SCHEDULE

PILE MARK	PILE SIZE	QUANTITY	PILE LENGTH	REMARKS
TOTALS				

TABLE OF ELEMENTS FOR PRESTRESSED CONCRETE PILING

PILE SIZE 'D'	AREA OF PILE SECTION SQ. IN.	I IN. ⁴	WEIGHT LB./FT.	1/2"φ - 270K LL STRANDS		
				QUANTITY 28.9k	INITIAL PRESTRESS FORCE KIPS	FINAL PRESTRESS (15% LOSS) P.S.I.
12" φ	142	1,680	148	6	173	1,035
14" φ	194	3,110	202	6	173	760
16" φ	254	5,340	265	8	231	774
18" φ	322	8,600	336	10	289	763
20" φ	398	13,150	415	14	405	864
24" φ	574	27,380	598	18	520	770

TABLE OF ELEMENTS FOR PRESTRESSED CONCRETE PILING

PILE SIZE 'D'	AREA OF PILE SECTION SQ. IN.	I IN. ⁴	WEIGHT LB./FT.	1/2"φ - 270K LL STRANDS		
				QUANTITY 31.0k	INITIAL PRESTRESS FORCE KIPS	FINAL PRESTRESS (15% LOSS) P.S.I.
12" φ	142	1,680	148	4	124	742

GENERAL NOTES

- CONCRETE FOR PRESTRESSED PILING SHALL BE CLASS H EXCEPT AS NOTED.
RELEASE STRENGTH FOR CLASS H CONCRETE = 4000 PSI.
MINIMUM COMPRESSIVE STRENGTH 28 DAY (f'c) = 5000 PSI.
- ALL CORNERS SHALL BE CHAMFERED AS SHOWN OR NOTED.
- ALL DIMENSIONS RELATING TO REINFORCING OR PRESTRESSING STEEL ARE TO CENTERS OF BARS OR STRANDS.
- SPIRAL HOOPING SHALL BE ASTM A-82 .207"φ MIN.
- PILE SHOULD BE SUPPORTED AT THE PICKUP POINTS AS SHOWN.
- TOLERANCES PER PCI-MNL-135-00.
- ALL PILING TO BE CAST WITH CONCRETE USING TYPE I or II CEMENT.
- PRESTRESS STRAND TO BE SEVEN-WIRE 1/2"φ 270 GRADE LOW RELAXATION ASTM A-416.
- STRAND SHALL BE PULLED TO 28.9K or 31.0K.

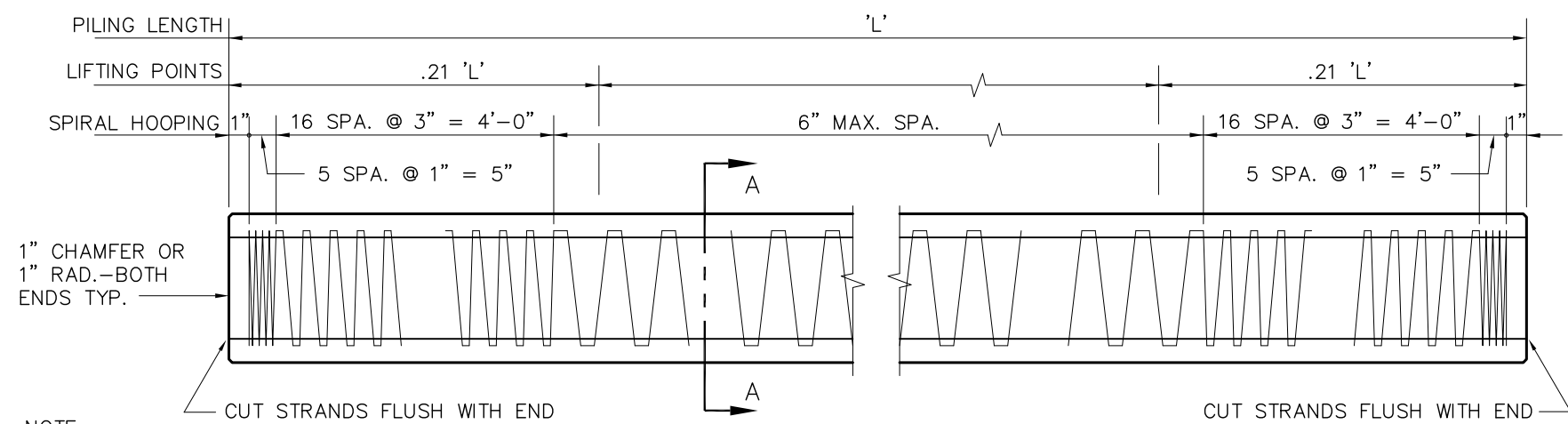

NOTE:
PILING SHALL BE HELD FIRMLY IN THIS POSITION ⊕ (HORIZ.) THROUGHOUT ALL LIFTING AND HANDLING OPERATIONS.

DETAIL OF PILING

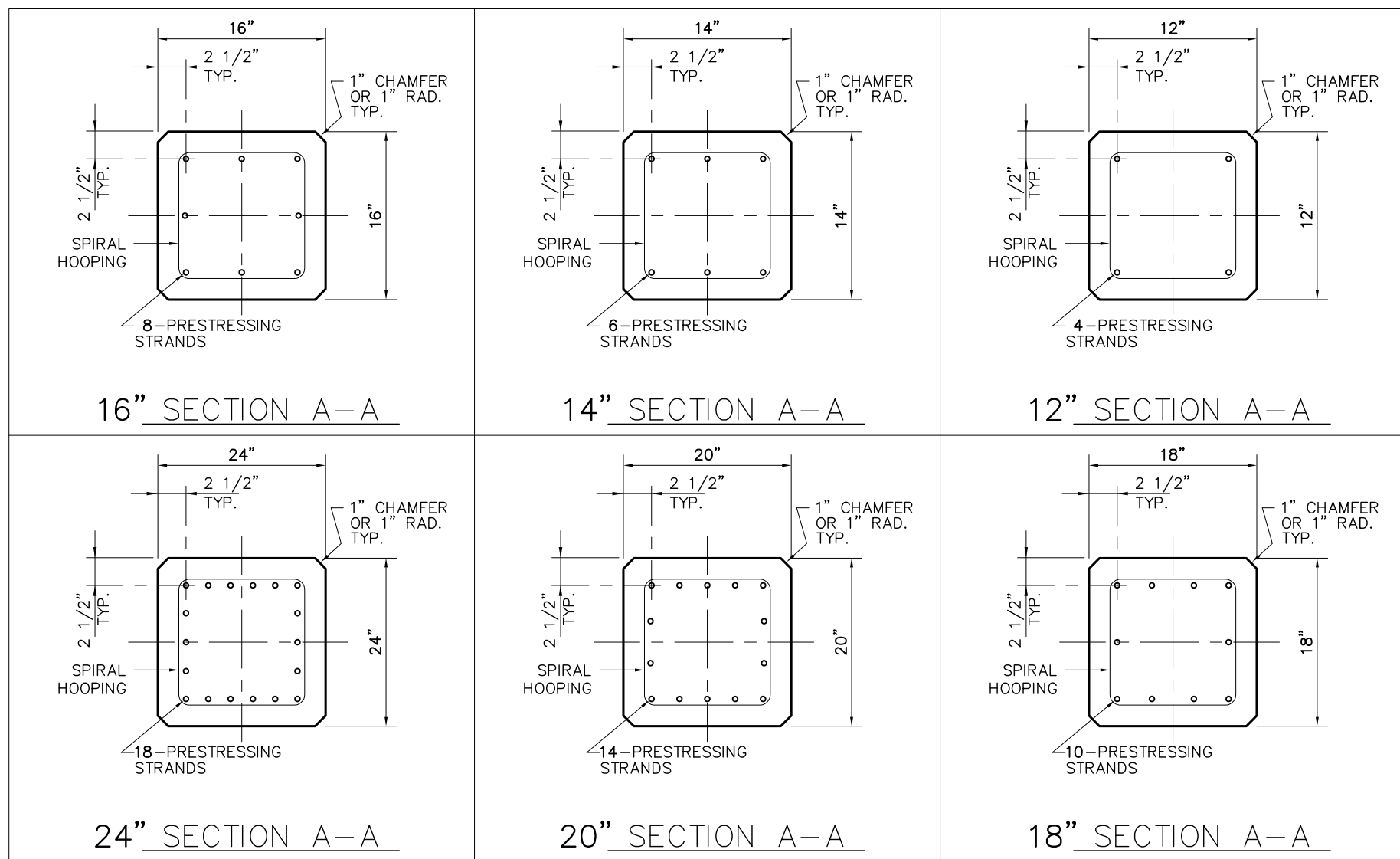

REVISIONS			
△			
△			
△			
△			
△			

PROJECT: **STANDARD PILE**
 LOCATION:
 CONTRACTOR:
 CONTROL NUMBER: — P.O. NUMBER: —
 PROJECT NUMBER: —
 ENGINEER:

P.O. BOX 450049 HOUSTON, TEXAS 77245
 PHONE: 888-359-4267 FAX: 281-437-8913

DRAWN BY:
CHECKED BY:
DATE:
FILE NAME:
JOB NUMBER:
PAGE: 1 OF 1